

# Tefal®

KING SIZE

FR

NL

DE

EN



[www.tefal.com](http://www.tefal.com)

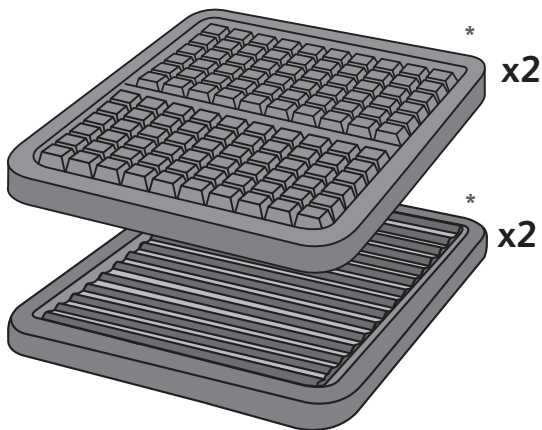
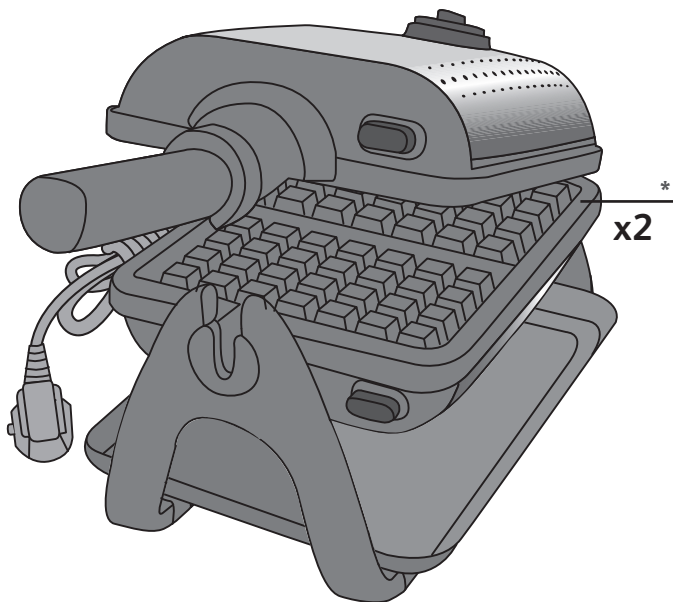

\*Selon modèle  
afhankelijk  
van het model  
je nach Modell  
depending  
on the model

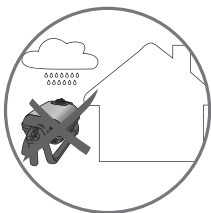
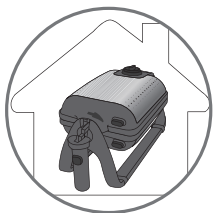
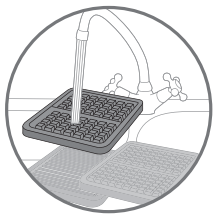
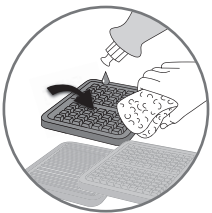
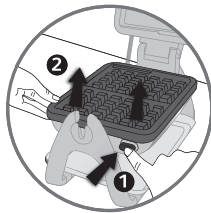
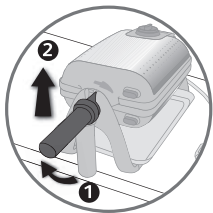
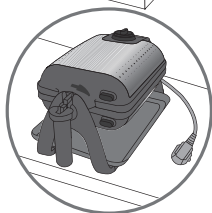
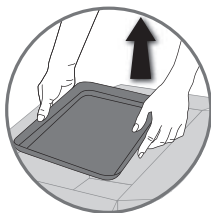
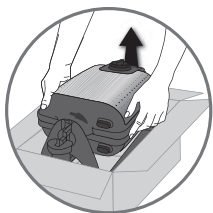
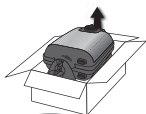
**A****B**

C

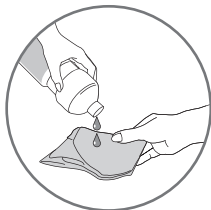
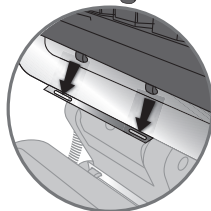
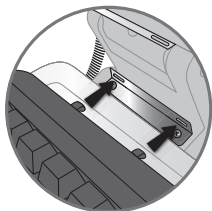
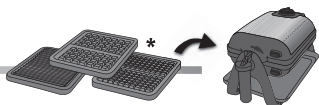

D

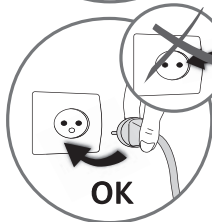
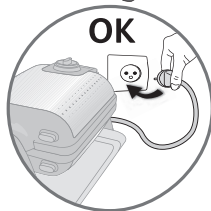
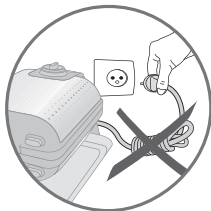

E

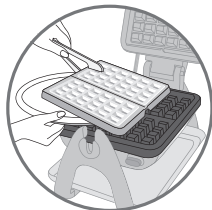
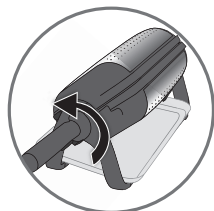
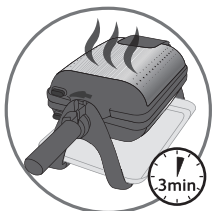
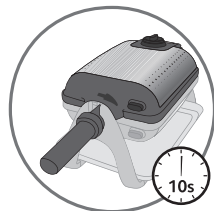
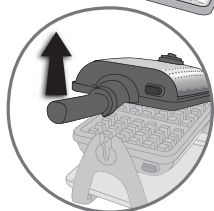
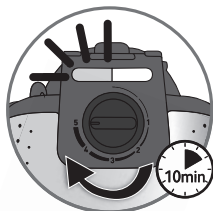
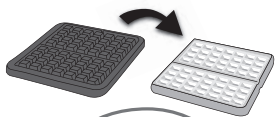

F

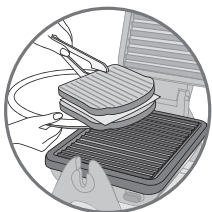
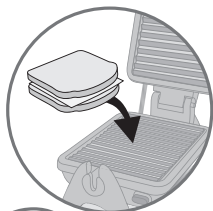
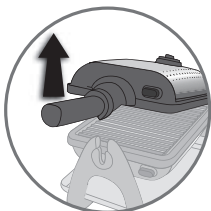
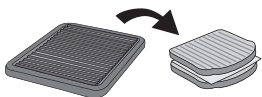

G

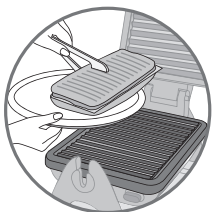
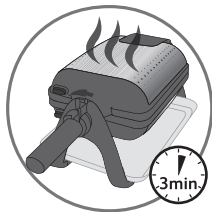
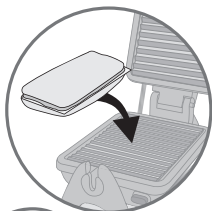
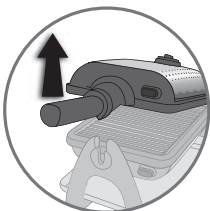
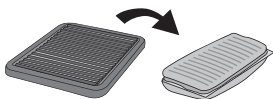



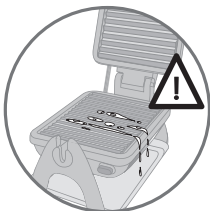
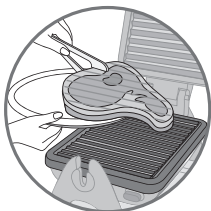
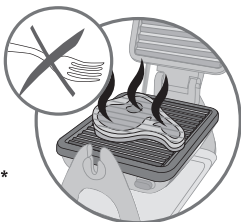
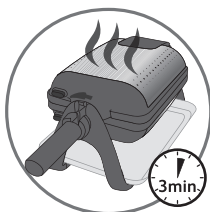
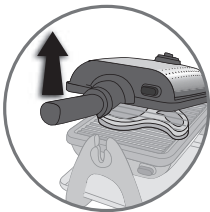
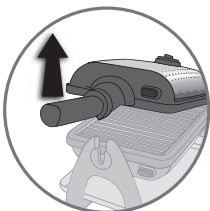
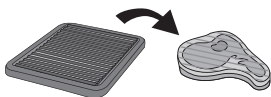









# H



\*\* à ajuster en fonction du type de viande - aanpasbaar afhankelijk van het soort vlees - je nach Fleischart einzustellen - to be adjusted depending on the type of meat

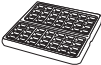

			 T°
		3 - 5 min	<b>5</b>
	 x2	5 min	
		8 min	
	 x2	5 min	
 x6		9 min	
		3 min	
		3 min	
		3 min	

I

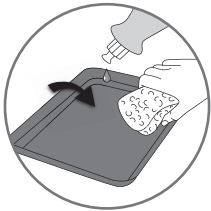
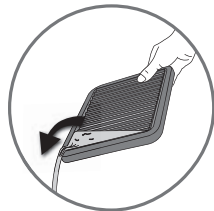
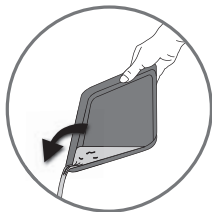
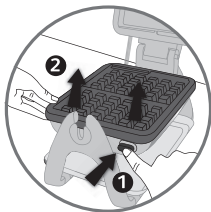
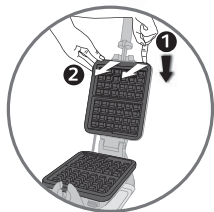
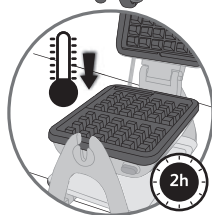
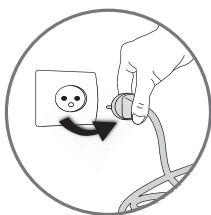

J

